

Design and specifications are subject to change without notice for improvement. Company names and product names mentioned in this document are trademarks or registered trademarks of the respective companies / entities.

## PRECAUTIONS FOR SAFE USE

**⚠ Warning:** To avoid hazards that may result in death or serious injuries, follow the instruction below carefully.

- Do not disassemble or modify the product.
- Do not expose the product to water or other liquids. Do not touch this product or cables with wet hands.
- If you notice unexpected odor or smoke, discontinue use of the product.
- Do not stack the product on top of each other or place heavy objects on the products.
- Make sure no foreign objects such as liquid or metal get inside the product.
- Keep away from children.
- To avoid overheat or ignition, do not use the product with the cable bundled up.

**⚠ Attention:** To avoid personal injuries or property damage, follow the instructions carefully.

- Be careful when installing and removing. (It may cause equipment failure)
- Do not use in the following environments where safe functioning of the product may be affected.
  - (1) Direct sunlight.
  - (2) Humid or damp place.
  - (3) Unstable surface.
  - (4) Place where static electricity is generated.
  - (5) Environment that is improper for the normal household or office application.
- The product may get hot after a long-time usage. Handle with care to avoid burns.
- Handle with care.
  - (1) Disconnect this product from your device such as a computer before cleaning.
  - (2) Clean the product with a soft cloth.
  - (3) Do not use benzene to clean the product.

## HANDLING PRECAUTIONS

- To avoid loss of data, make sure all the data have been saved on your computer before disconnecting the product.
- DO NOT disconnect this product or remove the SD/TF cards during read/write of data. Always disconnect/eject the peripherals such as SD cards in accordance with the requirements of your computer system and the related hardware.
- The seller/manufacturer shall not be held responsible for any loss of data associated with use of this product for any reason whatsoever.

## FEATURES

- This product allows you to connect your device to HDMI display, VGA display, USB devices, SD/TF card with one USB-C cable.
- The HDMI and VGA ports allow you to expand your display in two ways: Extend and Mirror without the need to install any software.
- With power input (max 100W) via the PD port, you can charge your device (such as a laptop) and other devices/peripherals such as smartphones and other USB-enabled devices.

## PHYSICAL CONDITIONS OF THE DEVICE TO BE PLACED

### Maximum weight capacity

- Do not place any device larger than the mounting surface of 11.8 x 8.5 in or weighing over 22 lbs (10 kg) on top of the product.

### Installation conditions

- This product shall be placed on a smooth and level area that is no less than 11.8 x 8.5 in.

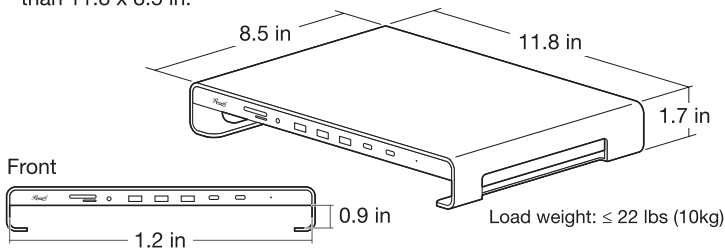

# FUNCTIONS OF THE PARTS

## SD slots

Read/write the SD card information



miniSD  
card x 1  
(SDHC)



SD  
memory card  
(Ver.1.1)  
(SDHC)



SDXC  
memory card

## x3 USB-A 3.0 Ports

Peripheral devices with USB A connection can be connected



Flash drive



HDD



Mouse



Keyboard

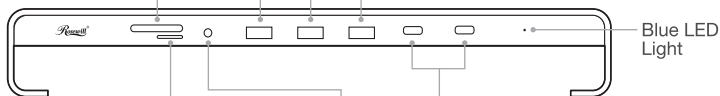

Blue LED  
Light

## microSD slots

Read/write microSD cards



miniSD  
card x 1  
(SDHC)



SD  
memory card  
(Ver.1.1)  
(SDHC)



SDXC  
memory card

## x2 USB 3.0 Type-C Ports

Connect peripheral devices with USB Type-C connection



Flash drive



HDD



Mouse



Keyboard

## 3.5mm 4-pole stereo port

Connect headsets and speakers



## VGA port

Connect VGA compatible displays

## HDMI port

Connect HDMI compatible displays



## PD port

USB-C port for power input only  
Supports USB PD for PC, etc.

## USB Type-C cable

Connect this product to a host device

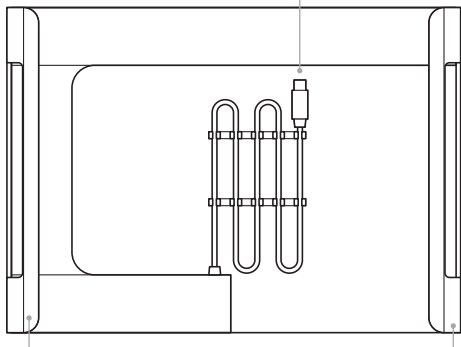

## Silicon strip

Prevents this product from skidding.

## PREPARATION BEFORE USE

1. Peel off the protective tape on the anti-skid strips

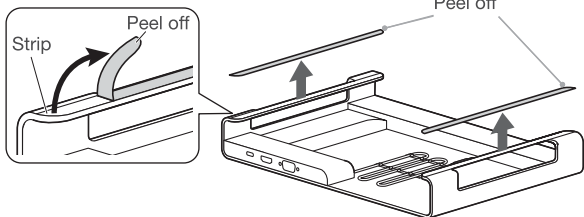

2. Take out the cable from the cable holder

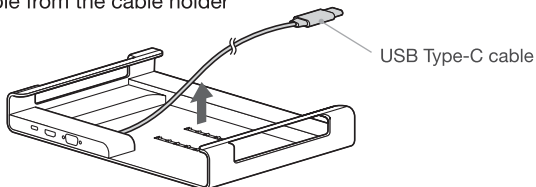

3. Place an all-in-one computer or monitor on top of the product

• **For Monitor**

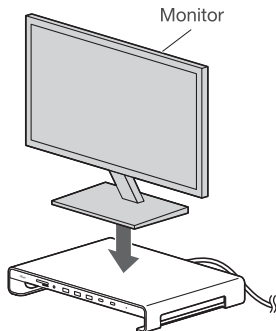

• **For All-in-1 computer**

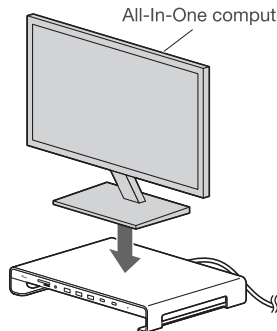

**! Turn on the power of the connected computer.**

4. Connect the USB Type-C cable of this product to the USB Type-C port of your computer. Insert it all the way in.

5. No drive software installation is needed

**For Monitor**

• Connect the cable to the USB-C port on your host device and connect the monitor to this product with a proper cable via the VGA or HDMI port.

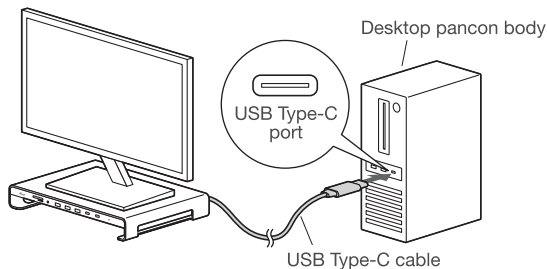

## For All-In-One computer

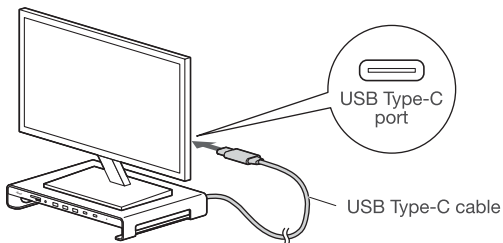

**⚠ Connect the computer to this product with the cable**

6. The LED lights up in blue and you can now start your work

## HOW TO USE

### Connect to USB-A enabled devices

The USB 3.0 Gen1 ports of this product can be used to connect USB-A devices (not included in the package).

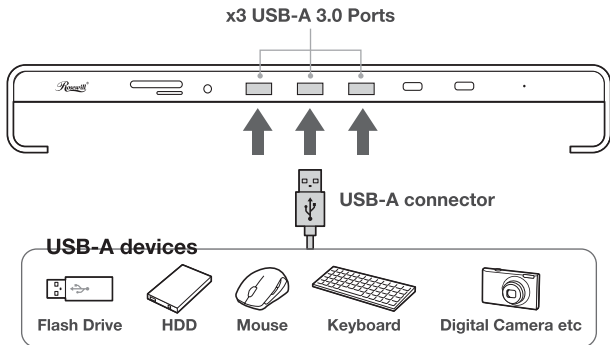

**⚠ High power consumption may not be supported.**

## Connect to USB-C enabled devices

The USB-C ports on the front side can be used to connect to USB-C enabled peripherals/devices such as flash drives, keyboards, etc.

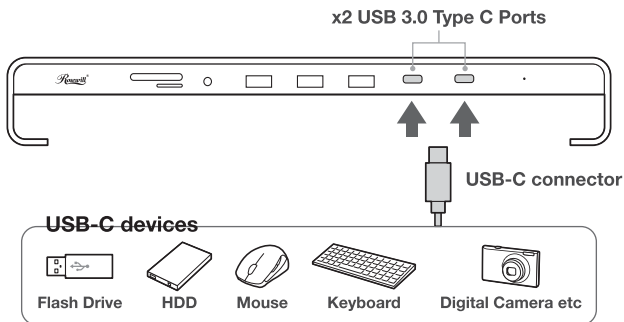

**⚠ High power consumption may not be supported.**

## Insert SD card microSD card

Insert SD card

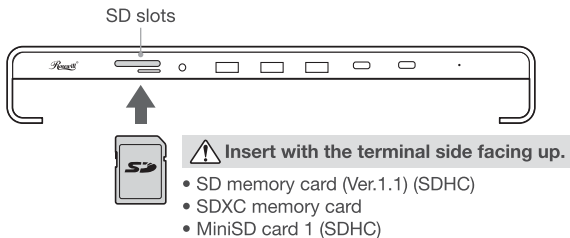

## Insert microSD card

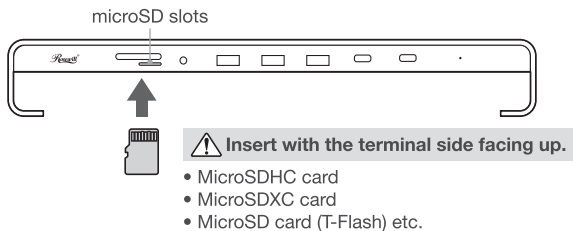

## Connect to a headset / speaker

Connect a headset / speaker (sold separately) to the 3.5mm 4-pole stereo port of this product.

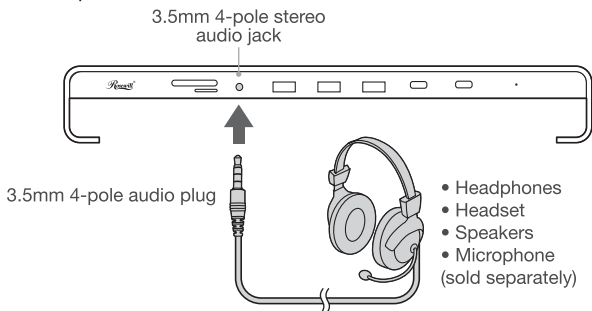



## Connect to HDMI/VGA devices

### Connect to HDMI device

Connect the HDMI port on the back side to an HDMI enabled display device/monitor.

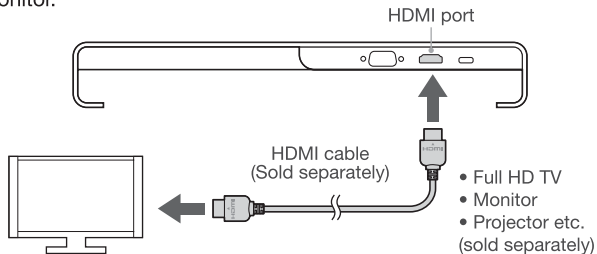

### Connect to VGA device

Connect the VGA port on the back side to an VGA enabled display device/monitor.

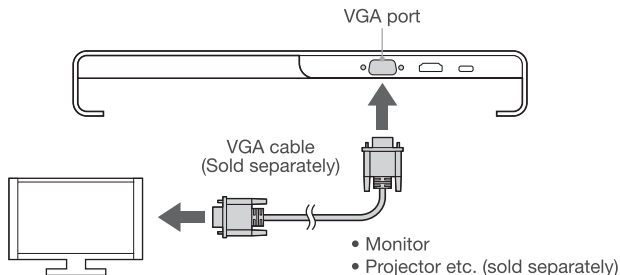

## Charge your notebook

The USB-C port on the back side supports USB PD (Power Delivery). You can charge your notebook computer by connecting to this port.

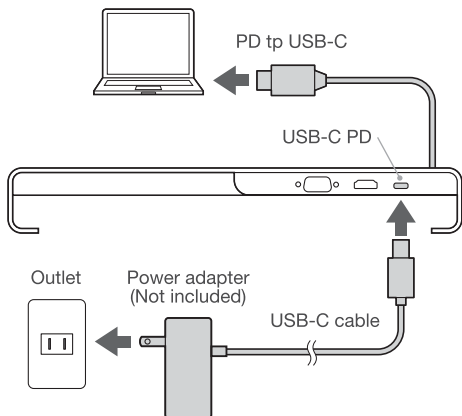

**⚠ Be sure to use a genuine AC adapter and cable**

## DEVICE AND OS COMPATIBILITY

### Compatible models

- Windows installed computers
  - Apple Mac Series
- \* To operate in the environment of USB 3.0 Gen1, a USB-A 3.0 Gen1 port is required on the host device.
- \* Some products may not be compatible with some USB devices.
- \* Be sure to connect a genuine power adapter for power input.

### Supported Operating System

- Windows 10
- Mac OS 10.12 - 10.15

# SPECIFICATIONS

## USB HUB

Interface standard	USB 3.0 Gen1 Backward compatibility: USB 2.0
Data transfer speed	5 Gbps / 480 Mbps / 12 Mbps / 1.5 Mbps (theoretical value)
Connection	USB 3.0 Gen1Port x3 (Downstream) USB Type-C Port x2 (Downstream) USB Type-C port x1 (PD 3.0 100W for charging only)
Power supply	Power input via the PD-compatible USB-C port (100W)
Supply current	Maximum 830 mA (total of all ports)

## HDMI port, VGA port

Connection	HDMI (19 pin) Female x1 (Max 4K 30Hz) HDCP 1.4 compatible VGA (O-Sub 15pin) Female x1 (Max 1920 x 1200 60Hz)
------------	--

## Card reader slots

Slot	SD memory card slot x1, microSD card slot x1
------	--

## Audio port

Audio port	3.5 mm 4-pole stereo
------------	----------------------

## General specifications

Current consumption	Up to 900 mA
Size / Weight	W11.8 x D8.5 x H1.7 in / 1.8 pounds approx. Cable length: 23.6 in Approx.



Technical Support Information [techsupport@rosewill.com](mailto:techsupport@rosewill.com) 1-800-575-9885

Please register your product at [www.rosewill.com](http://www.rosewill.com) for complete warranty information and support for your product.



RHUB-20006\_A