

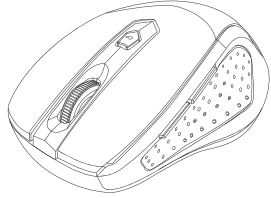

2.4 GHz Wireless Mouse
Souris sans fil 2,4 GHz
Ratón inalámbrico de 2,4 GHz



User's Manual
Manuel de l'utilisateur
Manual del usuario
RM-7800

English

Rosewill RM-7800 2.4 GHz Wireless Mouse
Thank you for purchasing a high-quality Rosewill Product.

Package Contents

- Wireless Optical Mouse x 1
- USB Nano Receiver x 1
- Quick User Guide x 1

Compatibility

- USB 1.1 / 2.0 / 3.0
- Compatible with Windows® XP / Vista / 7 / 8

Hardware Installation

Set up the mouse

Step 1 : Remove the battery housing cover located on the bottom side of the mouse.



Step 2 : Install one (1) AA battery into the battery housing. (Make sure to insert according to the polarity signs marked in the housing.)

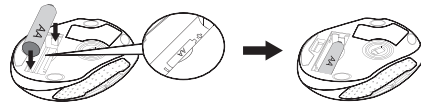

Step 3 : Close the battery housing cover.

Step 4 : Plug the USB Nano receiver into an available USB port on your computer.

Step 5 : Once Windows has detected the mouse, it will automatically install the software drivers required. Once this process is complete, the mouse is ready to use.

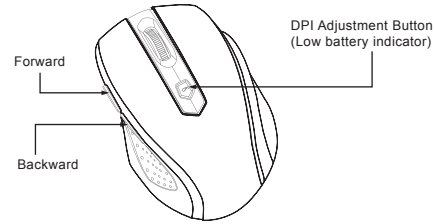

Features

1. DPI adjustment

Press the DPI adjustment button on the mouse to switch between 800 / 1200 / 1600 DPI.
1 Flash = 800 DPI / 2 Flash = 1200 DPI / 3 Flash = 1600 DPI

2. Low Battery Indicator

Please change the battery when the LED is continuously flashing.

3. Sleep Mode

If the mouse has not been used for 8 minutes, it will go into sleep mode to conserve battery life. Click the left or right mouse button to wake the mouse.

Note:

This device complies with part 15 of the FCC Rules. Operation is subject to the following two conditions: (1) This device may not cause harmful interference, and (2) this device must accept any interference received, including interference that may cause undesired operation.

FCC Statement

This equipment has been tested and found to comply with the limits for a Class B digital device, pursuant to part 15 of the FCC rules. These limits are designed to provide reasonable protection against harmful interference in a residential installation. This equipment generates, uses and can radiate radio frequency energy and, if not installed and used in accordance with the instructions, may cause harmful interference to radio communications. Any changes or modification not expressly approved by the party responsible could void the user's authority to operate the device.



Rosewill Technical Support Information
1-800-575-9885 Monday - Friday 8AM - 5PM PST
techsupport@rosewill.com

Thank you for purchasing a High-Quality Rosewill Product.
Please register your product at : <http://www.rosewill.com>
for complete warranty information and future support for your product.

Specifications

Specs	Product Description
2.4 GHz Optical Wireless Mouse with Nano Receiver	
Model Number	RM-7800 series
Dimensions	103.40 (L) x 71 (W) x 2.8 (H) mm 4.07 (L) x 2.80 (W) x 1.50 (H) inches
Weight	60 g
Color	Pink / Black
Material / Finish	Plastic / UV coating
Storage / Size	Right-hand
Speed	800, 1200, 1600 (DPI)
Voltage	1.5V
Power	2.4 GHz RF
Power Source	USB Receiver
Battery Type	x 1 AA
Cord Length	Wireless
I/O Connector	USB 3.0
Windows OS	XP / Vista / 7 / 8

Français

Rosewill RM-7800 Souris sans fil 2,4 GHz
Nous vous remercions de votre confiance dans la qualité supérieure de notre produit Rosewill.

Contenu de la boîte

- Souris optique sans fil
- Nanorécepteur USB
- Guide d'installation rapide

Compatibilité

- USB 1.1 / 2.0 / 3.0
- Compatible avec Windows® XP / Vista / 7 / 8

Installation du matériel

Installation de la souris

Étape 1 : Ouvrez le couvercle du compartiment des piles (dessous la souris sans fil).



Étape 2 : Installez une pile 1x AA dans le compartiment des piles. (Prenez soin de respecter la polarité indiquée dans le compartiment des piles.)

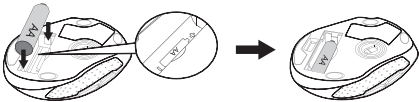

Étape 3 : Fermez le couvercle du compartiment des piles de la souris.
Étape 4 : Branchez le nanorécepteur USB dans un port USB disponible de votre ordinateur

Étape 5 : Lorsque Windows a détecté la souris, les pilotes du logiciel seront automatiquement installés. Une fois l'opération terminée, vous pouvez utiliser la souris

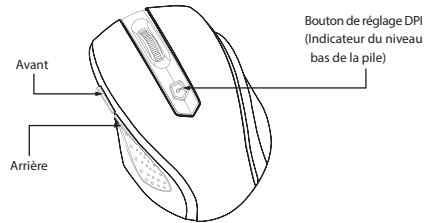

Caractéristiques

1. Réglage DPI

Appuyez sur le bouton de réglage DPI de la souris pour passer entre 800 / 1200 / 1600 DPI.
1 clignotement = 800 DPI ; 2 clignotements = 1200 DPI ; 3 clignotements = 1600 DPI

2. Indicateur du niveau bas de la pile

Veillez changer la pile lorsque la diode LED clignote en continu

3. Mode Veille

Si la souris n'est pas utilisée pendant 8 minutes, elle passe en mode de veille pour économiser la vie utile de la pile. Appuyez sur le bouton gauche ou droit de la souris pour l'activer.

Español

Rosewill RM-7800 Ratón inalámbrico de 2,4 GHz
Gracias por adquirir un producto de alta calidad de Rosewill.

Contenido del paquete

- Ratón óptico inalámbrico
- Nanorreceptor USB
- Guía de instalación rápida

Compatibilidad

- USB 1.1 / 2.0 / 3.0
- Compatible con Windows® XP / Vista / 7 / 8

Instalación del hardware

Preparar el ratón

Paso 1 : Abra el compartimento de la pila que se encuentra en el lado inferior del ratón inalámbrico



Paso 2 : Instale la pila de tipo en su compartimento. (Tenga en cuenta los símbolos de polaridad que se encuentran en el compartimento de las pilas.)

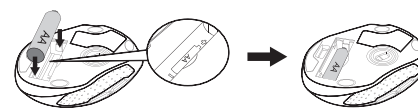

Paso 3 : Cierre la tapa del compartimento de las pilas.

Paso 4 : Enchufe el nanorreceptor USB en un puerto USB disponible del equipo.

Paso 5 : Cuando Windows haya detectado el ratón, instalará automáticamente los controladores de software requeridos. Una vez completado el proceso, el ratón estará preparado para utilizarse.

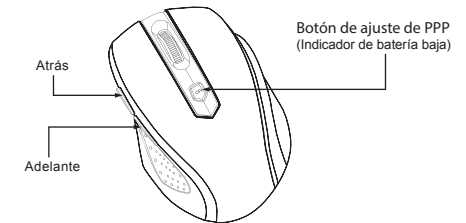

Características

1. Ajuste de PPP

Presione el botón de ajuste de PPP del ratón para cambiar entre 800, 1200 o 1600 PPP.
1 parpadeo = 800 PPP, 2 parpadeos = 1.200 PPP, 3 parpadeos = 1.600 PPP

2. Indicador de carga baja de la batería

Cambie la batería cuando el LED parpadee de forma continua.

3. Modo de suspensión

Si el ratón no se utiliza durante 8 minutos, entrará en el modo de suspensión para ahorrar energía de la pila. Presione el botón del ratón Izquierda o Derecha para reactivarlo.