

RX356-U-LCD

3.5" HDD/SSD Enclosure

User Manual



Read and Save This User Manual

Please thoroughly read this manual before setting up your unit. Failure to comply with the requirements and instructions could cause personal injury and/or property damage.

I. System Requirements

- Hardware Requirement: PC, Notebook, Mac; USB 3.0 port
- Operation System: Windows XP/Vista/7/8 (32/64) Mac OS X v. 10.4+
- Power Source: AC wall jack

II. Key Features

- Backward compatible SATA and USB 3.0
- For 3.5" HDD/SSD
- LCD display shows baud rate/transmission status
- Transfer rate up to 5 Gb/sec with USB 3.0
- Hot-Swap/Plug & Play
- Sleek, modern, black aluminum design

III. Package Contents

- See Figure 1 for the package content icons.
- External HDD/SSD Enclosure x 1
 - Enclosure Stand x 1
 - 12V Power Supply x 1
 - USB A-B 3.0 Cable x 1
 - Screw Pack x 1
 - User Manual x 1

Figure 1



1.

2.

IV. Enclosure Details

Refer to Figure 2 & 3 for the details of your enclosure.

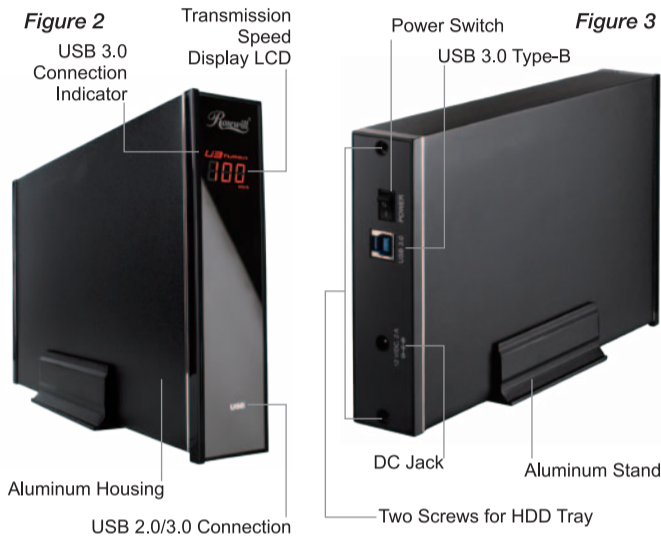

3.

Warning: Make sure the enclosure is secure and safe so it will not be accidentally bumped. Don't move the dock when it is in use because data and HDD damage can occur.

V. Installing Drivers

Windows OS and Mac OS will automatically detect the setup. After the install/setup, the icon will appear on your system toolbar.

VI. Setting Up

1. Attach USB and power cables (Figure 4).
2. Turn on the enclosure.

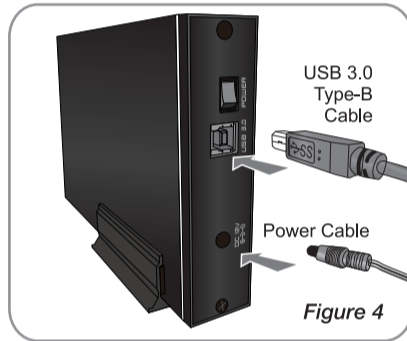

4.

VII. Installing an HDD

Refer to section to IV. Enclosure Details and Figure 3 to locate the HDD tray.

1. Unscrew the back of the enclosure and slide out the drive tray (Figure 5).

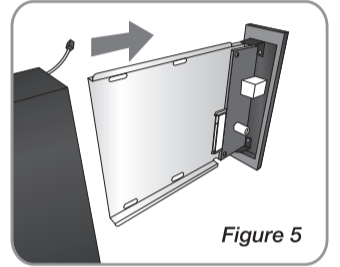

Figure 5

2. Place the HDD inside and secure against the tray. (Figure 6).

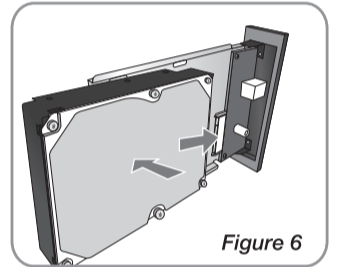

Figure 6

3. Slide the HDD connector into the tray connector. (Figure 6).
Do not bend or damage the I/O pin connections.

5.

4. Screw the HDD to the tray with the screws included in the screw pack (Figure 7).

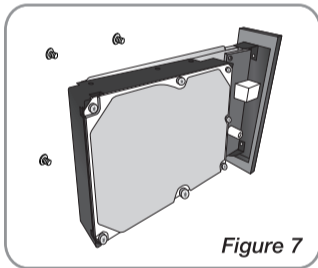

Figure 7

5. Return the HDD tray inside the enclosure, but do not push it completely shut (Figure 8 & 9).

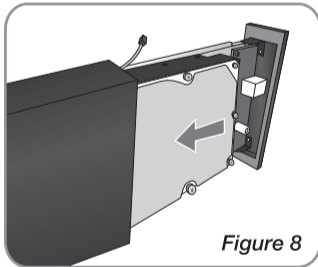

Figure 8

6.

6. Connect the LED cable to the PCB on the tray (Figure 9).

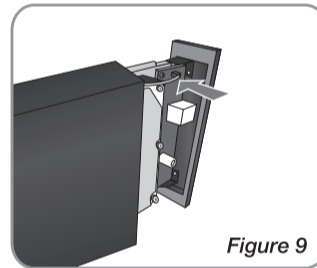

Figure 9

7. Push the HDD tray completely shut against the enclosure.

8. Screw it shut to safeguard the HDD stays connected and is protected (Figure 10).

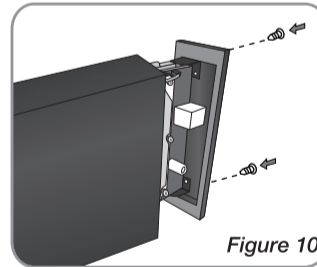

Figure 10

7.

8.

VIII. Notes

1. Different OS and different computers take a different amount of time to recognize the enclosure.
2. If you are attaching the newly configured external HDD/SSD to the PC or Mac for the first time, please wait for 1 minute for the system to recognize the hardware.
3. If your HDD or SSD is new, it may have to be formatted. See OS instructions from the manufacturer or publisher.
4. Before turning on the power, please make sure the HDD is properly installed.
5. Do not take out HDD/SSD while it is in on. It could cause damage.
6. Window XP (32) has a max. capacity of a 2 TB HDD. (Please check Windows official website for details.)
7. Please turn off and unplug the enclosure for long term storage.

Disclaimer

All the information in this document is subject to change without prior notice. The manufacturer makes no representations or any warranties regarding the contents of this manual. The information contained in this manual is provided for the general use by the customers. No part of this document may be reproduced or transmitted in any form by any means without the expressly written permission of the manufacturer. All brand Names used in this document are trademarks or registered trademarks of their respective holders.

9.

Specifications

3.5" Hard Drive Enclosure

Part Number	17-182-355
Model	RX356-U-LCD
Dimensions	7.85 x 5.04 x 1.26 inch 200 x 128 x 32 mm
Storage / Size	3.5" SATA HDD Bay
Voltage	12V/2A
Power	DC
Weight	1.7 lb
Color	Black
Material / Finish	Aluminum and Plastic
Cord Connector Interface	Wall outlet (Power); USB (Computer)

10.



Rosewill Technical Support information
1-800-575-9885 Monday - Friday 8AM - 5PM PST
techsupport@rosewill.com

Thank you for purchasing a quality Rosewill Product.
Please register your product at : www.rosewill.com
for complete warranty information and future support for your product.